



MODEL: RCAF-LMF/RD

INSTALLATION AND OPERATION INSTRUCTIONS

IF YOU CANNOT READ OR UNDERSTAND THESE INSTALLATION INSTRUCTIONS DO NOT ATTEMPT TO INSTALL OR OPERATE

INTRODUCTION

This remote control system was developed to provide a safe, reliable, and user-friendly remote control system for gas heating appliances. The system can be operated manually from the transmitter.

TRANSMITTER

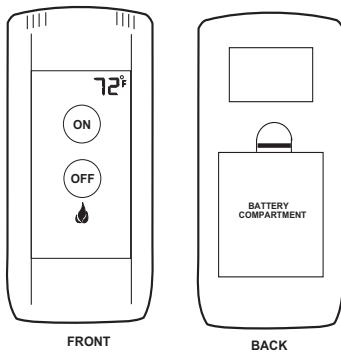

The transmitter operates on (4) AAA 1.5V batteries that are included. Install the batteries supplied with the unit into the battery compartment. It is recommended that ALKALINE batteries always be used for this product. **Be sure the batteries are installed with the (+) and (-) ends facing the correct direction.**

When you start up the remote, if a low battery signal appears or if they LCD screen does not illuminate when you touch it, check the position of the transmitter's batteries, and if the batteries are fully charged.

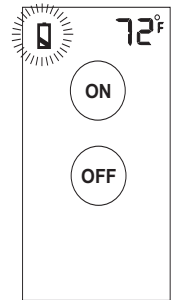

KEY SETTINGS AND LIQUID CRYSTAL DISPLAY (LCD)

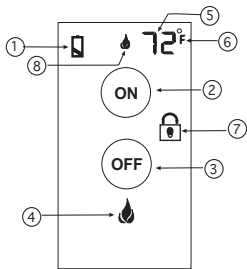

1. **BATTERY ICON** - Battery power is low. Replace batteries within two weeks.
2. **ON BUTTON** - Turns the appliance ON.
3. **OFF BUTTON** - Turns the appliance OFF.
4. **FLAME ICON** - Indicates the appliance is ON.
5. **ROOM TEMPERATURE DISPLAY**- Indicates current room temperature.
6. **FAHRENHEIT OR CELSIUS** - Indicates degrees Fahrenheit (°C indicates degrees Celsius).
7. **LOCK ICON** - Indicates child proof lockout is activated.
8. **RF SIGNAL ICON** - Appears when Radio Frequency (RF) signal is being transmitted.

MANUAL FUNCTION

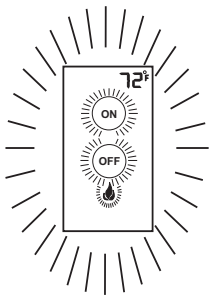

ON OPERATION

- Touch anyplace on the screen and the screen's blue back light will light up and stay on for 5-seconds.
- Touch the **ON** button on the LCD screen to turn the appliance on. The flame icon will appear on the LCD screen.

OFF OPERATION

- Touch the **OFF** button on the LCD screen to turn the appliance off. The flame icon will disappear from the LCD screen.

SETTING FAHRENHEIT / CELSIUS SCALE

The factory setting for temperature is °F. To change this setting to °C, press and hold the **ON** button and the **FLAME ICON** on the transmitter LCD screen at the same time for 5-seconds. Follow this same procedure to change from °C back to °F.

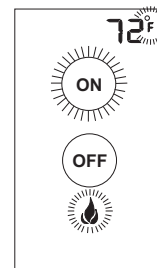

CHILDPROOF “LOCK-OUT”

This remote control includes a childproof “LOCK-OUT” feature that allows the user to “lock-out” operations from the transmitters.

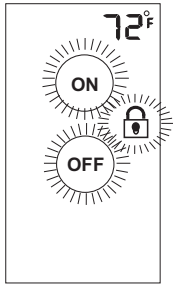

- To activate the “LOCK-OUT” feature, press and hold the **ON** and **OFF** icons on the LCD screen together, for 5 seconds. The lock icon will appear on the LCD screen.
- To disengage the “LOCK-OUT”, press and hold the **ON** and **OFF** icons on the LCD screen together, for 5 seconds. The lock icon will disappear on the LCD screen.

NOTE: If the appliance is already operating in the ON mode engaging the “LOCK-OUT” will not cancel the operating mode.

RECEIVER

Install the (4) AA-size batteries supplied with the unit. It is recommended that ALKALINE batteries always be used for this product. **Be sure the batteries are installed with the (+) and (-) ends facing the correct direction.**

The remote receiver has a 2-position slide switch for selecting the mode of operation **REMOTE/OFF**

- **REMOTE:** will allow use of handheld transmitter. If the system does not respond to the transmitter on initial use, check the battery positions in the remote. If that does not work, see the LEARNING TRANSMITTER TO RECEIVER section.
- **OFF:** will disable the remote receiver.
- **It is suggested that the slide switch be placed in the OFF position if you will be away from your home for an extended period of time.**

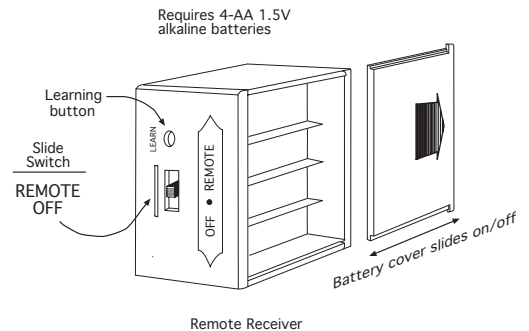

WARNING

This remote control system must be installed exactly as outlined in these instructions. Read all instructions completely before attempting installation. Follow instructions carefully during installation. Any modifications of this remote control or any of its components will void the warranty and may pose a fire hazard.

Do not connect any gas valve or electronic module directly to 110-120VAC power. Consult gas appliance manufacturer's instructions and wiring schematics for proper placement of all wires. All electronic modules are to be wired to manufacturer's specifications.

The following wiring diagrams are for illustration purpose only. Follow instructions from manufacturer of gas valve and/or electronic module for correct wiring procedures. Improper installation of electric components can cause damage to electronic module, gas valve and remote receiver.

INSTALLATION

The remote receiver should be placed on or near the fireplace hearth. The remote receiver should be kept away from temperatures exceeding 130° F. Battery life is also significantly shortened if batteries are exposed to temperatures 130°F or higher.

Before installation make sure the remote receiver slide switch is in the **OFF** position. After installation be sure that the slide switch is moved to the **REMOTE** position.

HEARTH MOUNT

- The remote receiver can be placed on the fireplace hearth or under the fireplace behind the control access panel.
- Use the wires attached to the remote receiver to connect to the gas valve or the electric module (Female spade connectors are provided).

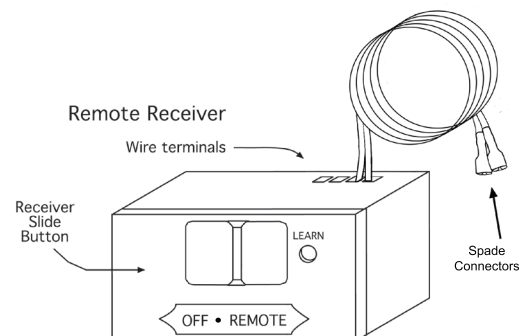

INSTALLING THE ON/OFF SOLENOID

1. Remove the two screws from the front metal faceplate on the AF-LMF valve box and set the face plate aside.
2. Take a screwdriver (flat head), and remove the aluminum valve cap fitting.

NOTE: KEEP THE VALVE CAP FITTING. IF THE SOLENOID IS REMOVED, THE CAP WILL NEED TO BE REPLACED.

3. Take the ON/OFF solenoid and install it in to the threaded hole where the brass cap fitting was. Do not overtighten.
4. Replace the metal faceplate on the front of the valve. Make sure that the red and black wires on the solenoid can reach out the back of the metal box, so that they can connect to the receiver.

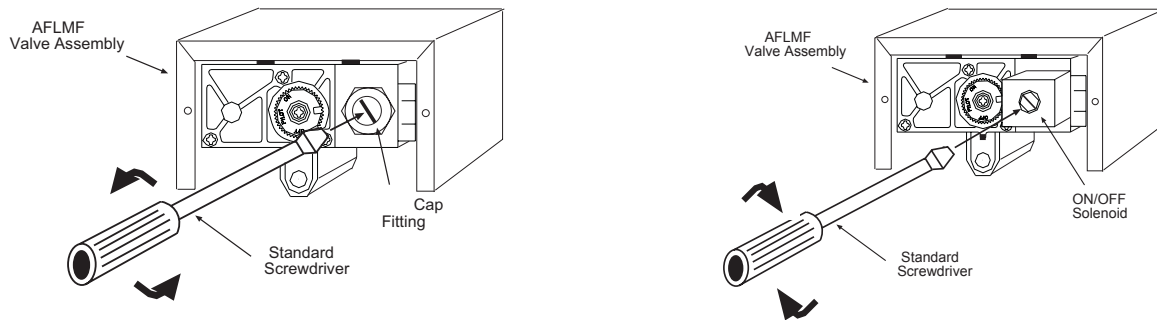

CONNECTING THE RECEIVER TO THE AF-LMF VALVE KIT

1. Connect the Black wire on the receiver with the Black wire on the solenoid.
2. Connect the Red wire on the receiver with the Red wire on the solenoid.
3. After the wires are securely connected, put the receiver shield on the receiver and place it where ambient temperatures do not exceed 130° F.

NOTE: The colors of the wires must match, if they do not, the functions of the receiver will not work.

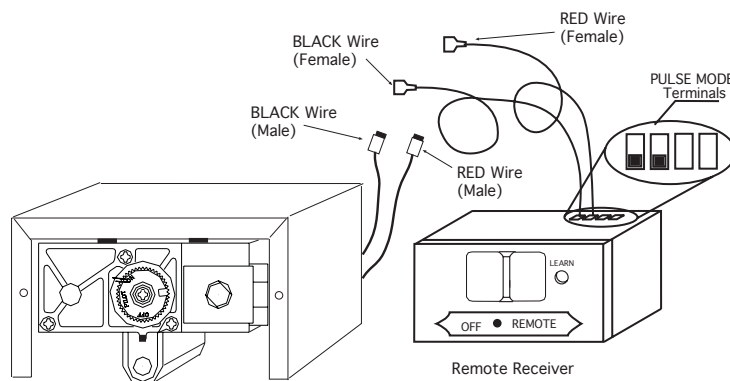

LEARNING TRANSMITTER TO RECEIVER

This transmitter has one of 1,048,576 unique security codes. It may be necessary to program the remote receiver to learn the security code of the transmitter upon initial use, if batteries are replaced, or if using a replacement transmitter.

- Make sure the receiver's slide switch is in the **REMOTE** position.
- Press and release the **LEARN** button on the receiver.
- When you hear the "Beep", press and hold the **ON** or **OFF** button for about 2 seconds on the transmitter.
- You will then hear a series of "rapid" beeps that indicate your new transmitter has been accepted by the receiver.

BATTERY LIFE

Life expectancy of the alkaline batteries in the transmitter and receiver should be at least 12 months. Check and replace all batteries:

- Annually.
- When operating range becomes reduced.
- When transmissions are not received by the remote receiver.
- If the remote receiver batteries measure less than 5.3 volts (all four batteries in combination).
- If the hand held transmitter battery measure less than 5.3 volts (all four batteries in combination).

TROUBLE SHOOTING

If you encounter problems with your fireplace system, the problem may be with either the fireplace itself or with the remote. Review the fireplace manufacturer's operation manual to make sure all connections are properly made. Then check the operation of the remote in the following manner:

- Make sure all batteries are correctly installed in the transmitter and receiver. Also check that the batteries are fully charged.
- Check batteries in transmitter to make sure contacts are touching (+) and (-) ends of battery. Bend metal contacts in for tighter fit.
- Ensure receiver and transmitter is within 20 to 25-foot operating range.
- Keep receiver from temperatures exceeding 130° F. Battery life will be shortened if exposed to high temperatures.
- If receiver is installed in a tightly enclosed metal surrounding, the operating distance will be shortened.
- Make sure the hand-held transmitter and remote receiver are communicating properly (see Learning transmitter to receiver section).

FCC REQUIREMENTS

NOTE: THE MANUFACTURER IS NOT RESPONSIBLE FOR ANY RADIO OR TV INTERFERENCE CAUSED BY UNAUTHORIZED MODIFICATIONS TO THE EQUIPMENT. SUCH MODIFICATIONS COULD VOID THE USER'S AUTHORITY TO OPERATE THE EQUIPMENT

For Technical Service, call:

U.S. INQUIRIES

(855) 498-8324 or (260) 459-1703

CANADIAN INQUIRIES

(877) 472-3923

For Sales: (888) 672-8929
Web site: www.skytechpg.com

MANUFACTURED EXCLUSIVELY FOR SKYTECH II, INC