



**MODEL: RCAF-1035**

**INSTALLATION AND OPERATION INSTRUCTIONS**

**IF YOU CANNOT READ OR UNDERSTAND THESE INSTALLATION INSTRUCTIONS DO NOT ATTEMPT TO INSTALL OR OPERATE**

**INTRODUCTION**

This remote control system was developed to provide safe, reliable, user-friendly remote control system for gas heating appliances. The system can be operated manually from the transmitter. It operates a HI/MED/LO step motor.

**TRANSMITTER**

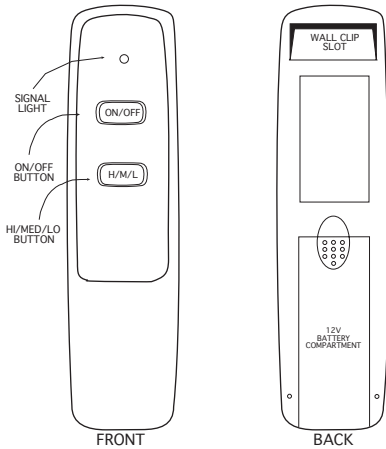

The transmitter operates on a 12-volt (A23) battery that is included. Install the 12V battery supplied into the transmitter battery compartment. It is recommended that ALKALINE batteries always be used for this product. **Be sure the battery is installed with the (+) and (-) ends facing the correct direction.**

The LED signal light should illuminate when either the **ON/OFF** or **HI/MEDIUM/LOW** button is pressed. If the signal light does not illuminate, check the position of the transmitter's battery, and if the battery is fully charged.

**KEY SETTINGS**

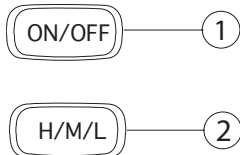

1. **ON/OFF** - This turns the appliance ON or OFF.
2. **H/M/L** - This controls the height of the flame. It has three levels; High, Medium, Low

**IMPORTANT**

**THE REMOTE RECEIVER SHOULD BE POSITIONED WHERE AMBIENT TEMPERATURES DO NOT EXCEED 130° F.**

**RECEIVER**

Install the (4) AA-size batteries supplied with the unit. It is recommended that ALKALINE batteries always be used for this product. **Be sure the batteries are installed with the (+) and (-) ends facing the correct direction.**

The remote receiver has a 2-position slide switch for selecting the mode of operation, which is **OFF/REMOTE**.

- **REMOTE:** The receiver must be in this position if you want to use the appliance, you must use the transmitter to turn ON the appliance. If the system does not respond to the transmitter on initial use, check the battery positions in the remote. If that does not work, see the **LEARNING TRANSMITTER TO RECEIVER** section.
- **OFF:** Disables the remote receiver.
- **It is suggested that the slide switch be placed in the OFF position if you will be away from your home for an extended period of time.**

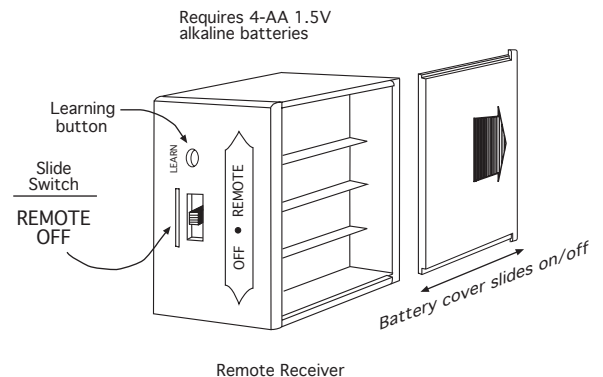

## WIRING INSTRUCTIONS

### WARNING

**DO NOT CONNECT REMOTE RECEIVER DIRECTLY TO 110-120VAC POWER. THIS WILL BURN OUT THE RECEIVER. FOLLOW INSTRUCTIONS FROM MANUFACTURER OF GAS VALVE FOR CORRECT WIRING PROCEDURES. IMPROPER INSTALLATION OF ELECTRIC COMPONENTS CAN CAUSE DAMAGE TO GAS VALVE AND REMOTE RECEIVER.**

### CONNECTING THE RECEIVER TO THE AF-LMF VALVE KIT WITH THE HI/MED/LO STEP MOTOR

- **Do not install the 4-AA batteries into the receiver until the DC Step Motor is connected to the receiver.** The receiver will calibrate the step motor once the batteries are installed.
- Connect the 4-pin female connector from the DC step motor to the 4-pin male connector on the wire harness.
- Connect the 4-pin female connector on the wire harness to the 4-pin connector on the back of the receiver.
- Install the 4-AA batteries in to the receiver.
- After receiver is connected to the DC step motor using the supplied wire harness, make sure the plastic receiver shield (Included) is located over the receiver, then locate the receiver in an area that will not exceed the 130° F. This location will always be away from the AF-LMF, towards the front of the firebox.

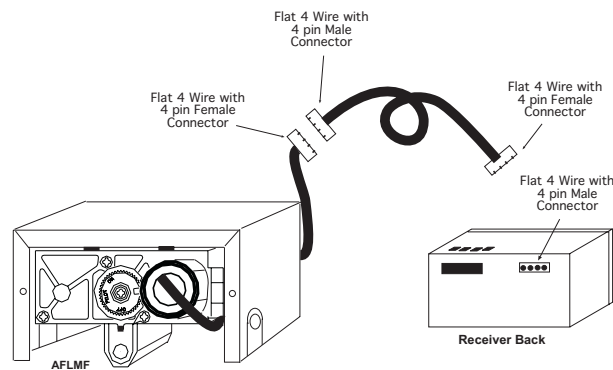

### THERMO-SAFETY FEATURE

When the ambient temperature inside the receiver case reaches 130°F, the RECEIVER will automatically send power to the step motor on the valve to shut the fireplace system off and the RECEIVER will begin emitting a series of four (4) “beeps” every 2-seconds. When the ambient temperature at the RECEIVER drops between 120° F and 130° F, the user can reactivate the fireplace by pushing **ON/OFF** button on the transmitter. When the ON/OFF button is pressed, the THERMISTOR “resets” itself and the fireplace will begin operating again. However, the “beeping” will continue if the ambient temperature remains between 120° F and 130° F. This “beeping” alerts the user that the RECEIVER should be repositioned so the ambient temperature drops below 120° F. When the temperature drops below 120° F, and the control is reset by pressing the **ON/OFF** button, the “beeping” will cease.

### LEARNING TRANSMITTER TO RECEIVER

Each transmitter has a unique security code. It may be necessary to program the remote receiver to learn the security code of the transmitter upon initial use, if batteries are replaced, or if using a replacement transmitter.

**NOTE:** This receiver can hold up to 3 transmitter codes. This is for the times when a second hand held transmitter or a wall transmitter is required.

- Make sure the receiver’s slide switch is in the **REMOTE** position.
- Press and release the **LEARN** button on the receiver.
- When you hear the “Beep”, press and hold the **ON/OFF** or **H/M/L** button for about 2 seconds on the transmitter.
- You will then hear a series of rapid beeps that indicate that your new transmitter has been accepted by the receiver.
- If you press the **LEARN** button on the receiver and you hear no beeps, the receiver is unable to retain any more transmitter codes (make sure that the transmitter and the receiver batteries are properly installed and fully charged).
- To delete all of the transmitter codes on your receiver, press and hold the **LEARN** button for 10 seconds. Then you will hear a series of three (3) long beeps, indicating that the receiver’s memory has been cleared.

## **TRANSMITTER WALL CLIP**

The transmitter can be hung on a wall using the clip provided.

- Wood - Drill 1/8" pilot holes and install with screws provided.
- Plaster/Wallboard - Drill 1/4" holes, tap plastic anchors in with hammer, then install with the screws provided.

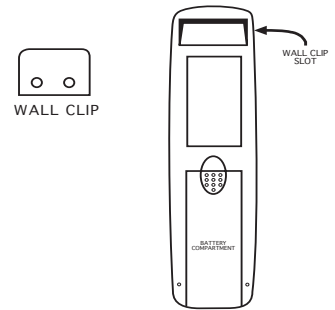

## **BATTERY LIFE**

Life expectancy of the alkaline batteries in the transmitter and receiver should be at least 12 months. Check and replace all batteries:

- Annually.
- When operating range becomes reduced.
- When transmissions are not received by the remote receiver.
- If the remote receiver batteries measure less than 5.3 volts (all four batteries in combination).
- If the hand held transmitter battery measure less than 9.0 volts.

## **TROUBLE SHOOTING**

If you encounter problems with your fireplace system, the problem may be with either the fireplace itself or with the remote. Review the fireplace manufacturer's operation manual to make sure all connections are properly made. Then check the operation of the remote in the following manner:

- Ensure all batteries are correctly installed in the transmitter and receiver. Ensure all batteries are fully charged.
- Check batteries in transmitter to make sure contacts are touching (+) and (-) ends of battery. Bend metal contacts in for tighter fit.
- Be sure receiver and transmitter are within 20 to 25-foot operating range.
- Keep receiver from temperatures exceeding 130° F. Battery life will be shortened if exposed to high temperatures.
- If receiver is installed in a tightly enclosed metal surrounding, the operating distance will be shortened.
- Make sure the hand-held transmitter and remote receiver are communicating properly (see **LEARNING TRANSMITTER TO RECEIVER** section).

### **FCC REQUIREMENTS**

**NOTE: THE MANUFACTURER IS NOT RESPONSIBLE FOR ANY RADIO OR TV INTERFERENCE CAUSED BY UNAUTHORIZED MODIFICATIONS TO THE EQUIPMENT. SUCH MODIFICATIONS COULD VOID THE USER'S AUTHORITY TO OPERATE THE EQUIPMENT**

**For Technical Service, call:**

### **U.S. INQUIRIES**

(855) 498-8324 or (260) 459-1703

### **CANADIAN INQUIRIES**

(877) 472-3923

For Sales: (888) 672-8929

Web site: [www.skytechpg.com](http://www.skytechpg.com)

**MANUFACTURED EXCLUSIVELY FOR SKYTECH II, INC**